



BELVEDERE STONE

Exterior Stone Installation

Substrate Types

- 1 Sand cement screed – less than 2% (CM) moisture content
- 2 Concrete sub-base – less than 2% (CM) moisture content
- 3 Compacted hardcore – for sand and cement fixing only –
Mot type 1 at a suitable depth for intended use

Standards

- 1 Patios and terraces must have a minimum fall 1:80
- 2 Depth of concrete – minimum 75mm for paths and terraces,
driveways minimum 100mm for cars and a minimum of
200mm for commercial vehicles
- 3 Depth of compact Type 1 sub-base – minimum 75mm well
compacted for paths and patios

Fixing Method

- 1 Adhesive method – to be used for load bearing concrete
substrates
- 2 Sand cement plus slurry – use a 50-75mm bed of sand and
cement with an adhesive slurry applied to the back of the stone
- 3 Drainage mortar – prepacked fixing mortar to effectively
manage both ground and surface water

Drainage & Waterproofing

Install drainage membranes to effectively manage the effect of rainwater on stone. Waterproof concrete bases to reduce the impact of groundwater rising through the structure.

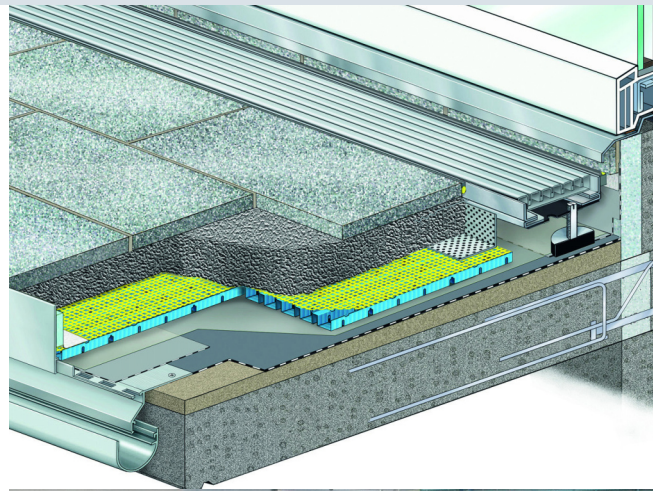

Stone Installation

Fix tiles using either BAL Rapid Flex One, BAL Pourable One or BAL Flex One. Solid bed fixing method with 100% coverage, achieved by applying adhesive to substrate and back of stone.

Movement Joints

Install preformed or site filled movement joints with a minimum width of 6mm at 5-8m intervals, around all perimeters and in line with all structural movement joints as described in BS 5385-3:2014.

Drying

Leave tiling to dry before grouting or moisture will be trapped below the stone and lead to discolouration and efflorescence.

Grout

Work in small areas, washing off excess grout before it dries on the surface of the stone as work progresses. Remove all grout residue with subsequent washes.

Builder's Clean

Spray EcoProTec Natural Stone Aftercare Cleaner diluted 1 :20 with warm water, leave for 5 minutes and rinse.

Sealing

Spray EcoProTec Natural Stone Sealer and leave to dry, repeat until saturation is achieved.

Maintenance & Cleaning

Spray EcoProTec Natural Stone Aftercare Cleaner diluted 1 :20 with warm water, leave for 5 minutes and rinse.

Please note: This is a simplified step by step guide to stone installation and is not a fixing specification.

Contact Belvedere Stone to receive a complete warranty-backed fixing specification for your project.

